



## *Hopewell Elementary School*



### **PHASING PLAN**

#### **Phase 1: New Building Construction**

**Start:** June 1, 2015

**Substantial Completion:** August 1, 2016

### **WORK COMPLETED**

#### **Site Work**

- No work performed.

#### **General Construction**

- Spray foam application 75% complete.
- Load bearing stud walls and exterior sheathing: 95 % complete.
- Brick veneer in areas B and C: 90% complete.
- Structural steel installation throughout entire building: 100% complete.
- Steel roof decking: 95 percent complete.
- Roof insulation and substrate: 95% complete.
- Shingle installation 85% complete.
- Above ceiling drywall:
  - 100% in area B and C
- Classroom partition walls 100% done area B and C.
- Window installation is 80% complete in areas B and C.

### **WORK PROJECTED FOR FEBRUARY 2016**

#### **Site Work**

- Continue working on underground storm system.

#### **General Construction**

- Continue application of spray foam insulation around perimeter of building.
- Finish roof insulation/substrate and complete installation of asphalt roof shingles.
- Continue laying rock-cast masonry and brick veneer around building (moving to area A).
- Complete Soffit framing in classrooms and start corridor soffit framing in Areas B&C.
- Continue installation of drywall for classroom walls.
- Complete window installation in area C.
- Continue field measurements for casework installation.
- Complete door frame installation in Areas B and C.
- Complete cold form metal truss installation in Area A.
- Complete building enclosure in area A.

**WORK COMPLETED (cont'd)****Plumbing Contractor**

- Domestic water rough-ins to classroom sinks and toilet rooms 85% complete.
- Sanitary vent and drain lines throughout building: 25% complete.

**Electrical Contractor**

- Electrical rough-ins in areas B & C: 90% complete. (Area B - inspection approved)
- Electrical feeder cable from main switch gear to Areas B & C pulled: 100%.
- Electrical panels set throughout building: 70% complete.
- Cable tray installation in area B & C: 90% complete.

**Mechanical Contractor**

- Drilling of geothermal wells proceeding, 104 out of 128 wells have been drilled.
- Duct work installation completed in 6 classrooms in Area B.
- Geothermal piping installation: 80% complete in Areas B & C.
- Concrete placed for 4 equipment pads in Areas B & C, 2 ERU units have been set onto pads.
- Geothermal underground feeder loops to building, completed from water retention basin to interior tie-in inside mechanical room.

**WORK PROJECTED FOR FEBRUARY 2016 (cont'd)****Plumbing Contractor**

- Complete installation of domestic water lines above ceiling (sinks & toilet rooms).
- Begin sprinkler piping installation in Areas B & C.
- Complete sanitary vent lines in Areas B & C.

**Electrical Contractor**

- Complete rough-ins in Areas B & C.
- Begin duct bank work feeding into the building.
- Continue to pull wire to junction boxes throughout building.
- Begin pulling wire into the cable tray.

**Mechanical Contractor**

- Continue drilling geothermal wells.
- Continue hanging ductwork throughout Areas B and C.
- Begin setting precast concrete pads for heat pumps in Areas B & C.
- Complete placement of concrete for equipment pads throughout building.
- Set mechanical units in place within mechanical rooms.

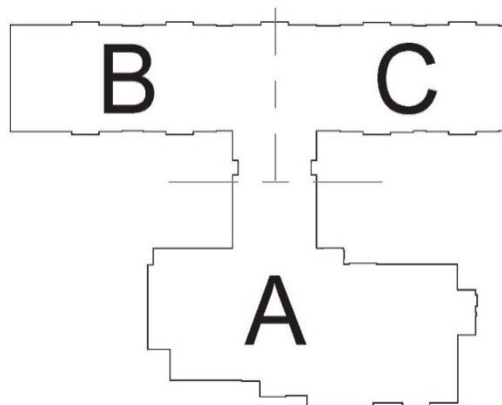
**Building Layout:**



Contractor	Original Contract Amount	Change Orders to Date	Updated Contract Amount	Amount Paid to Date	Amount Remaining
Lobar (GC)	\$ 10,448,500.00	\$ -	\$ 10,448,500.00	\$ 4,878,541.45	\$ 5,569,958.55
JBM (MC)	\$ 2,630,000.00	\$ 395,241.00	\$ 3,025,241.00	\$ 1,239,021.90	\$ 1,786,219.10
Albarell (EC)	\$ 2,013,538.00	\$ -	\$ 2,013,538.00	\$ 329,186.20	\$ 1,684,351.80
DeWalt (PC)	\$ 835,000.00	\$ -	\$ 835,000.00	\$ 337,021.47	\$ 497,978.53
Sargent (EAC)	\$ 86,988.00	\$ -	\$ 86,988.00	\$ -	\$ 86,988.00
Air Balancing Engineers	\$ 62,150.00	\$ -	\$ 62,150.00	\$ 7,956.00	\$ 54,194.00
Chrin	\$ 75,000.00	\$ -	\$ 75,000.00	\$ 2,490.69	\$ 72,509.31
Advantage - constr. testing	\$ 75,000.00	\$ -	\$ 75,000.00	\$ 28,128.88	\$ 46,871.12
<b>Total</b>	<b>\$ 16,226,176.00</b>	<b>\$ 395,241.00</b>	<b>\$ 16,621,417.00</b>	<b>\$ 6,822,346.59</b>	<b>\$ 9,799,070.41</b>
Contractor	Starting Allowance	Allowance Issued	Allowance Remaining		
Lobar (GC)	\$ 172,350.00	\$ 7,448.06	\$ 164,901.94		
JBM (MC)	\$ 121,000.00	\$ -	\$ 121,000.00		
Albarell (EC)	\$ 102,979.00	\$ 14,226.00	\$ 88,753.00		
DeWalt (PC)	\$ 40,125.00	\$ 19,170.05	\$ 20,954.95		
Sargent (EAC)	\$ 5,900.00	\$ -	\$ 5,900.00		
<b>Total</b>	<b>\$ 442,354.00</b>	<b>\$ 40,844.11</b>	<b>\$ 401,509.89</b>		